



NOW IS THE TIME

Seizing the moment, securing our future!

*I tell you, **now is the time** of God's favor, now is the day of salvation.*

2 CORINTHIANS 6:2





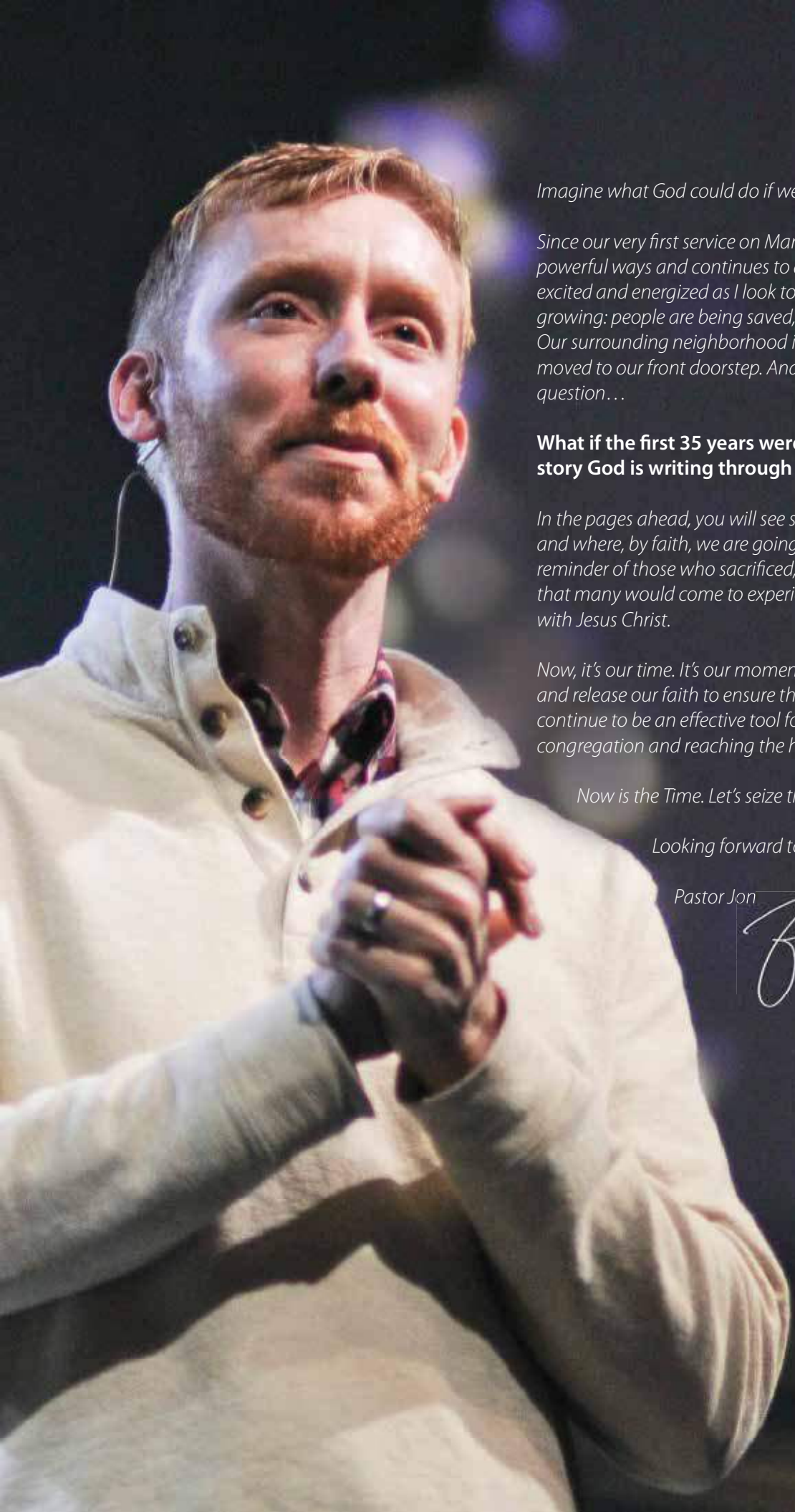

Imagine what God could do if we dared to dream bigger.

Since our very first service on March 25, 1990, God has moved in powerful ways and continues to do an amazing work. Today, I'm excited and energized as I look to the future. Our congregation is growing: people are being saved, baptized, set free, and delivered. Our surrounding neighborhood is expanding as the nations have moved to our front doorstep. And all this leads me to ask the question...

What if the first 35 years were just the beginning of the story God is writing through Northwoods?

In the pages ahead, you will see snapshots of where we have been and where, by faith, we are going. Let these pictures be a powerful reminder of those who sacrificed, prayed, and gave generously so that many would come to experience a life-changing encounter with Jesus Christ.

Now, it's our time. It's our moment to dream bigger, sacrifice more, and release our faith to ensure that our building and grounds continue to be an effective tool for ministering to the needs of our congregation and reaching the hearts of our neighbors.

Now is the Time. Let's seize this moment – together.

Looking forward to the future,

Pastor Jon

For he says, “In the time of my favor I heard you, and in the day of salvation I helped you.” I tell you, *now is the time* of God’s favor, now is the day of salvation.

2 Corinthians 6:2





Now truly is the time of God's favor—not tomorrow, not next year, but today. Will you join us in seizing this divine moment to expand our reach and impact for the Kingdom?

Ministering to Our Congregation

Our church is growing! It's time to dream about how we can better care for every person God has brought into our family. No matter the age, young or old, each stage of life brings unique needs and opportunities for ministry. Together, let's create spaces that better support and equip others on their journey with Christ.



*Now is the time to
further the mission
that has defined
Northwoods for more
than three decades.*

Reaching Our Neighbors

We have a conviction that the most effective churches moving forward will be those that get laser-focused on reaching their neighborhood. When we first broke ground on this property, our only neighbors were cornfields and country roads. Today, the landscape has changed drastically as countless homes and schools now fill the surrounding area. What an opportunity we have to ensure our building and grounds remain an inviting space to share the hope of Jesus with our neighbors!



Now is the time to move forward confidently, believing God will do immeasurably more than we can ask or imagine as we pursue Him and others.

History of Giving and Building

1996



Breaking New Ground

On March 8, the groundbreaking ceremony for Phase I of the building took place at the "Field of Dreams". That campaign allowed us to build our very first Auditorium, where the present-day Student Center is located.

1999



The Journey Continues

God abundantly blessed The Journey Continues campaign, which raised \$8.75 million for Phase II. Our current Auditorium was built during that campaign.

2003



Press On

Just as The Journey Continues came to a close, the Phase III campaign was launched. The joke became that The Journey Continues...and continues...and continues. That \$10 million campaign built the Atrium and created the space that we call Discoveryland.

2011



The 15:8 Project

Phase IV was our last major building campaign. That \$14 million campaign renovated the Student Center, opened the balcony in the Auditorium, upgraded our technology, and built the Prayer Tower.

Now is the time to expand our capacity to welcome those seeking the hope that only Jesus provides.

Summary of *Now is the Time* Projects

Goal #1: Create inviting spaces for our church and neighbors that serve as on-ramps into relationships with Christ and one another.

- **Building Maintenance**
\$4.3 Million
- **Atrium Redesign & Refresh**
\$1.2 Million
- **Indoor Playground**
\$2 Million
- **Children's Ministry Refresh**
\$785 Thousand

Goal #2: Support Northwoods families and ministry partners through life's milestones and challenges.

- **Chapel Construction**
\$6 Million
- **Guesthouse for Partners and Planters**
\$250 Thousand

Building Maintenance

GOAL 1



Now is the time to create welcoming spaces that promote ministry and show good stewardship.



- By creating a facility that is safe and welcoming, we invite everyone to participate fully in worship and community life.
- Our church building requires thoughtful renovation to continue serving its ministry purpose effectively. Our spaces are more than just rooms. They are more than just places to house the building's mechanical and technical systems. Our spaces are the physical embodiment of our ministry, the very spaces through which our congregation's conversations and connections flourish and deepen.
- Updating our facility demonstrates good stewardship of the resources God has entrusted to us. By modernizing outdated spaces and systems, we reduce maintenance costs, improve energy efficiency, and ensure our building serves us effectively for generations to come.
- When we update and maintain our meeting spaces, building, and grounds, it communicates that we believe the Word of God is alive and active - it is not some relic from the past.

Atrium Redesign & Refresh

GOAL 1

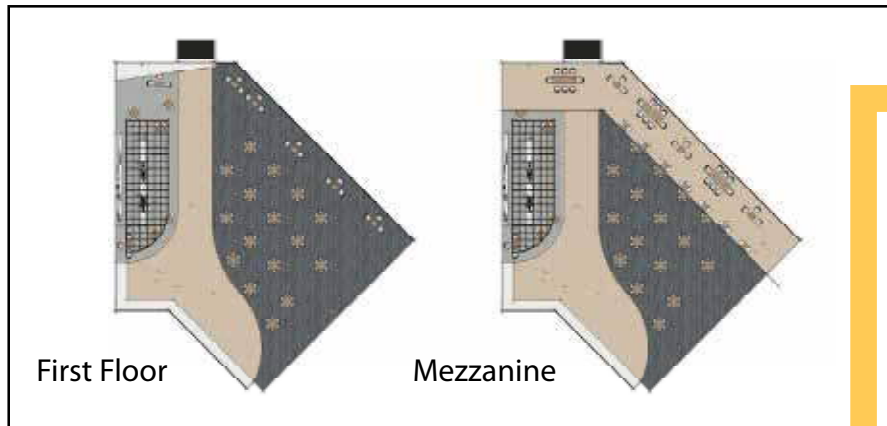

Now is the time to invest in spaces that facilitate the conversations, connections, and community that are central to our church's mission and growth.



- Redesigning our Atrium and Coffee Shop represents an investment in the vital conversations and connections that strengthen our church family.
- A warm, remodeled gathering space with a coffee shop communicates hospitality and helps visitors feel comfortable as they navigate their first experiences with our church.
- Beyond home and work, people need a comfortable “third space” to gather with friends, read, work, or create. Our Atrium and Coffee Shop can serve as this space for people in both our congregation and the surrounding neighborhoods.



Indoor Playground

GOAL 1



Now is the time to create a year-round space where children can play, families can connect, and the seeds of faith can be planted.



First Floor



Mezzanine

- Provides a consistent, weather-independent space for families to connect.
- Serves as an accessible entry point for unchurched families in our community.
- Demonstrates our church's commitment to serving families with young children.
- Functions as a community gathering space that can benefit everyone.
- Creates opportunities to host Christ-centered community events and activities.
- Attracts young families—often the demographic most crucial for church growth.

Children's Ministry Refresh

GOAL 1



Now is the time to ensure our physical spaces support the vital spiritual work happening in our children's ministry.

- Modernized children's areas can incorporate the latest safety features and security protocols to give parents peace of mind while their children are in our care.
- Updated spaces will be designed with specific age groups in mind, creating environments that engage children at their developmental level and make Bible learning more effective and memorable.
- Refreshed and expanded children's areas allow us to welcome more families and accommodate future growth in our congregation.
- For many families, the children's ministry area is their first and most important touchpoint with our church. Vibrant, well-maintained spaces communicate that we value children and prioritize their spiritual formation.
- By investing in our children's ministry spaces, we're not just updating rooms—we're creating environments where life-changing conversations happen, where young faith takes root, and where the next generation of believers begins their journey with Christ.

Chapel Construction

GOAL 2



Now is the time to consider how a Chapel could enhance our ministry capabilities, provide more opportunities for spiritual formation, and create a sacred space that serves both our current needs and our future vision as a church family.



- A Chapel creates a dedicated space that has a more appropriate atmosphere for weddings, funerals, and special prayer services where the Auditorium might feel overwhelming.
- A Chapel allows multiple ministry activities to occur simultaneously on our property, maximizing our ability to serve different groups within our congregation and community.
- By investing in a Chapel today, we're creating a legacy of faith that will serve our children and grandchildren, providing them with a special place to encounter God for years to come.

Guesthouse for Partners & Planters **GOAL 2**



First Floor



Basement



- Our church community needs dedicated spaces that support our mission and ministry. A Guesthouse represents an opportunity to extend our reach and deepen our impact in ways that complement our existing campus.
- A Guesthouse provides a welcoming space for visiting missionaries, guest speakers, and ministry partners, demonstrating our commitment to hospitality while reducing accommodation costs.
- A Guesthouse can serve multiple functions—housing for ministry interns or staff in transition, a place for counseling sessions, a youth gathering space, or a retreat location for leadership planning.

Now is the time to consider how a Guesthouse could enhance our ability to serve, connect, and grow as a church family while being good stewards of our resources.

Campaign Goals

Now is the time of God's favor—to transform our church, expand our ministry, and join together in faith as we answer His call to create momentum that will impact generations to come. Remember, our primary goal is 100% engagement. This is for everyone!

Campaign Length:

Dec. 1, 2025–Dec. 31, 2027



Celebration Goal:

\$8,000,000

Dream Goal:

(Fully Funded)

\$15,000,000

How Can We Make this Vision a Reality?

As we're called to give boldly and faithfully within our means, our gifts make a difference. This chart isn't just about numbers—it's about partnership, sacrifice, and unlocking what God can do through all of us together. **Not equal gifts, but equal sacrifice.**

| GIFTS NEEDED | GIFT AMOUNT | MONTHLY GIFT | GIFT LEVEL TOTAL | CUMULATIVE TOTAL | % OF TOTAL |
|--------------|-------------|--------------|------------------|------------------|------------|
| 1 | \$1,500,000 | \$60,000 | \$1,500,000 | \$1,500,000 | 10% |
| 1 | \$1,000,000 | \$40,000 | \$1,000,000 | \$2,500,000 | 17% |
| 2 | \$500,000 | \$20,000 | \$1,000,000 | \$3,500,000 | 23% |
| 5 | \$250,000 | \$10,000 | \$1,250,000 | \$4,750,000 | 32% |
| 10 | \$100,000 | \$4,000 | \$1,000,000 | \$5,750,000 | 38% |
| 25 | \$75,000 | \$3,000 | \$1,875,000 | \$7,625,000 | 51% |
| 25 | \$50,000 | \$2,000 | \$1,250,000 | \$8,875,000 | 59% |
| 30 | \$30,000 | \$1,200 | \$900,000 | \$9,775,000 | 65% |
| 40 | \$25,000 | \$1,000 | \$1,000,000 | \$10,775,000 | 72% |
| 50 | \$20,000 | \$800 | \$1,000,000 | \$11,775,000 | 79% |
| 60 | \$15,000 | \$600 | \$900,000 | \$12,675,000 | 85% |
| 70 | \$10,000 | \$400 | \$700,000 | \$13,375,000 | 89% |
| 80 | \$7,500 | \$300 | \$600,000 | \$13,975,000 | 93% |
| 90 | \$5,000 | \$200 | \$450,000 | \$14,425,000 | 96% |
| 100 | \$2,500 | \$100 | \$250,000 | \$14,675,000 | 98% |
| 125 | \$1,000 | \$40 | \$125,000 | \$14,800,000 | 99% |
| Many | Remainder | Various | \$200,000 | \$15,000,000 | 100% |

Prayer Guide

Now is the Time Campaign

For he says, “In the time of my favor I heard you, and in the day of salvation I helped you.” I tell you, *now is the time* of God’s favor, now is the day of salvation.

2 CORINTHIANS 6:2

Pray and ask the Lord what “sacrifice” looks like for you in this campaign.

Pray and ask the Lord to show you in what way he wants you to be involved with fasting and prayer for the church.

Pray that God would use this campaign as a catalyst to unite us together and grow us spiritually.

Goal #1: Create inviting spaces for our church and neighbors that serve as on-ramps into relationships with Christ and one another.

“Love the Lord your God with all your heart and with all your soul and with all your mind and with all your strength.’ The second is this: ‘Love your neighbor as yourself.’ There is no commandment greater than these.”

MARK 12:30-31

Pray for our neighbors who set foot on our campus and in our building, that it will be a great introduction to our church and that they would come to know the saving grace of Jesus.

Pray for the Gospel to reach the families in the neighborhoods surrounding Northwoods.

Pray for a greater sense of community and friendship to be built in our church and that love will be released from it!

Goal #2: Support Northwoods families and ministry partners through life's milestones and challenges.

Praise be to the God and Father of our Lord Jesus Christ, the Father of compassion and the God of all comfort, who comforts us in all our troubles, so that we can comfort those in any trouble with the comfort we ourselves receive from God.

2 CORINTHIANS 1:3-4

Pray that God would call out and raise up families who give their lives to planting churches both here in our country and around the world.

Pray for our partners around the world. Pray for health, safety, and greater effectiveness for Christ. Also, pray that this Guesthouse will be a place of rest and refreshment.

- Brazil North – Igreja Presbyteriana de Manaus (IPM)
- Brazil South – Light to the Nations Church (ILAN)
- Brazil South – Zoe Network
- Dominican Republic – Solid Rock International
- India North – Hope Partners International
- India South – Zion Evangelistic and Care Ministries (ZEC)
- Israel – Immanuel Church
- Israel – Hamaayan Congregation
- Zambia – Africa Church Planting Initiative
- Vietnam – Church Planting Institute

Pray that this Chapel would be a testament to the beauty of God's design for marriage and a place of comfort for families in the midst of loss.

Questions & Answers

How do I get involved?

You can begin to fast and pray, spending time in God's Word and in His presence, as you seek clarity on your gift to the Now is the Time initiative.

On Commitment Sunday, November 9, we will gather to make our financial commitments to the initiative as we trust God to enable us to fulfill them over the next 25 months. If you haven't already done so, there will be an opportunity to present our Courageous Gifts at this time. We will then give our first Consistent Gift between November 9 and the end of the year. Creative Gifts can be given at any time throughout the following 25 months.

How can I give to *Now is the Time*?

Courageous Gift

A one-time gift given on or before Commitment Sunday. This is in addition to your regular tithes and offerings or your Consistent Gift.

Consistent Gift

This is in addition to your regular tithes and offerings or your Courageous Gift. Consistent Gifts are given over the next 25 months.

Creative Gift

Consider giving things other than money. (For example: stocks or proceeds from the sale of other assets.)

- You can write a check. Put "Now is the Time" in the memo.
- You can give cash. Offering envelopes are available. Note "Now is the Time" on the envelope.
- You can give stocks, bonds, and other assets. Contact the Northwoods Finance Department to make arrangements.
- You can give online. Visit nowisthetime.church and click "Give" at the bottom of the page to set up a recurring gift or to make a one-time contribution.

What about my regular giving?

Our continued ministry is dependent upon God's people consistently honoring Him with their tithes and offerings. Your financial commitment to the Now is the Time initiative should be a gift over and above your regular giving.

Important Dates

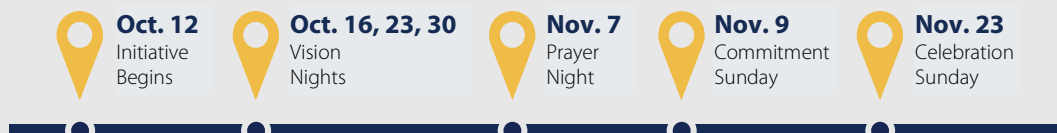

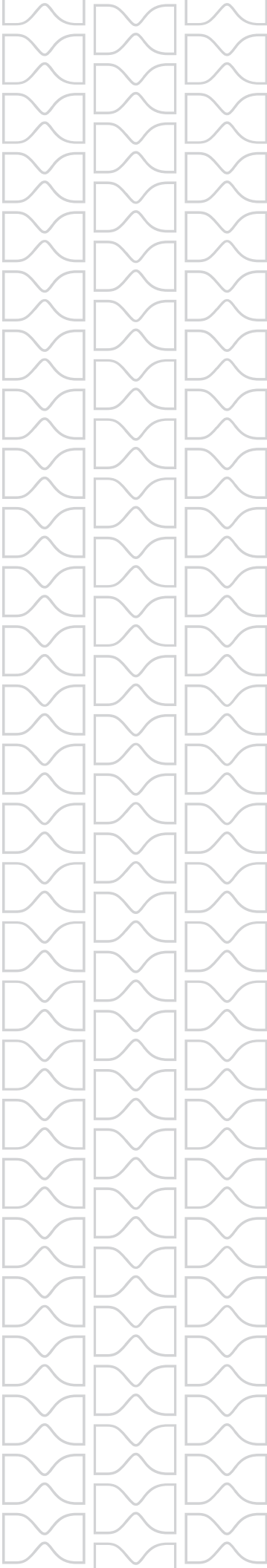



nowisthe**time**.church



northwoods
Hope lives here.

10700 N ALLEN ROAD, PEORIA, IL 61615 • 309-243-1550 • NORTHWOODS.CHURCH